

ALPHA WASH TH



The Alpha Wash TH is a washlight resulting from the experience of the Alpha Wash 575W, compared to which it offers two extra valuable features: the "Top Hat" for perfect control of the light beam and an indexable ovalizer.

It will be easy to play with color using this washlight, also thanks to the Color Mixing CMY, color wheel, linear CTO, linear frost, dimmer and stop/strobe effect.

Very bright, with a zoom of 4° - 50°, lightweight, silent and practical, Alpha Wash TH is suitable for all professional and entertainment environments.



PRELIMINARY EDITION



PROFESSIONAL SHOW LIGHTING

Product features

Lamp

575 W metal iodide lamp.

- Cap: G 22.
- Color temperature: 6,000 K.
- Luminous flux: 49,000 lm.
- Average life: 1,000 h.
- Hot lamp restrrike.

Optics

- Exceptionally reliable 575 W discharge lamp.
- New optical unit with optimal luminous efficiency.
- 4° - 50° electronic linear zoom.
- Fresnel Lens: diameter 200 mm, focal length 140 mm.
- *Top Hat* for a perfect control beam.

Colors and Effects

- CMY color mixing.
- Wheel fitted out for 4 colors, 2 of which (Congo Blue and Saturated Red) are supplied.
- Linear CTO.
- Linear Frost.
- Indexable Ovalizer with max aperture >80°.
- A state - of - the - art 0-100 % dimmer.
- Stop/strobe effect.

Standard Color Filters (Ø 57 mm)



080399/131
Saturated Red



080399/130
Congo Blue

Electronics and other features

- Long life self-charging buffer battery.
- Pre-set macros.
- "ENERGY SAVING" function: with the stop or total dimmer effect on, consumption cut by 50 %.
- 115/230V switchable power supply.
- ON/OFF lamp control from the lighting desk.
- Function reset from the lighting desk.
- "HELP" function in the menu.
- "MEMO" function.
- "AUTOTEST" function.
- Possibility to upgrade the software through the DMX 512 input.
- Ethernet connection.
- Electronic control on each parameter.
- DMX level monitoring on each channel.
- Feedback information for each sensor and encoder.
- Electronic repositioning of the effects.

Dimensions and Weights

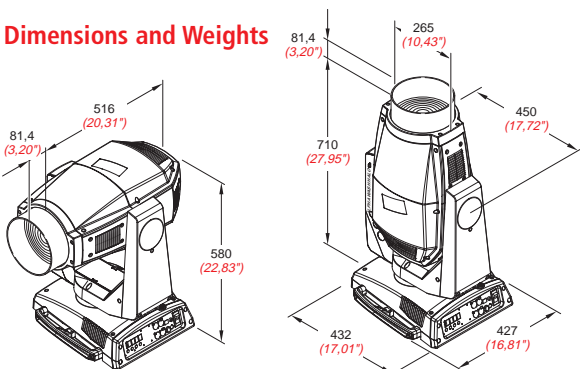

27 kg 59 lbs 6 ozs

ALPHA WASH TH: dimensions (mm/inches).

Technical data

Power supplies

• 200 - 240 V 50/60 Hz • 100 - 120 V 50/60 Hz
The power supply can be changed over with the built-in selector.

Input power: 850 VA at 230 V 50 Hz
(PFC Electronic Ballast).

Input: DMX 512.

Body

- Aluminium structure with die-cast plastic cover.
- Two side handles for transportation.
- Device locking PAN and TILT mechanisms for transportation and maintenance.

Moving body

- Angle:
 - PAN = 450° - TILT = 252°
- Maximum speeds:
 - PAN = 4.0 sec. (360°) - TILT = 3.2 sec. (252°)
- Resolution:
 - PAN = 1.76° - PAN FIN = 0.007°
 - TILT = 0.98° - TILT FIN = 0.004°
- Automatic repositioning of PAN and TILT after accidental movement not controlled by control unit.
- PAN and TILT lock on 4 and 5 positions respectively.

Cooling

Forced ventilation with axial fans.

Safety devices

- Bipolar circuit breaker with thermal protection.
- Automatic break in power supply in case of overheating.

Recommended working position

Functions in any position.

CE marking

In conformity with the European Union Low Voltage Directive 73/23 and Electromagnetic Compatibility Directive 89/336.

Accessories

Code 183102/801

Omega for Clamps fixing - supplied (2 pieces)



Code C52175

Clamps (hooks for truss) - not included



Code 105041/003

Safety cable - not included



Optional Color Filters (Ø 57 mm)

080399/101	Light Blue
080399/102	Yellow
080399/103	Green
080399/104	Violet
080399/105	Red
080399/106	Pink
080399/107	Orange
080399/110	Azure
080399/111	Dark Blue
080399/112	Medium Blue
080399/113	Dark Amber
080399/114	Dark Green
080399/115	Light Green
080399/116	Turquoise
080399/117	Primary Red
080399/119	Light Orange
080399/120	CTO
080399/121	CTB
080399/123	Magenta
080399/124	Deed Red
080399/125	UV light
080399/130	Congo Blue
080399/131	Saturated Red

Channels (Extended mode)

Channel 1	Cyan
Channel 2	Magenta
Channel 3	Yellow
Channel 4	Linear CTO
Channel 5	Color Wheel
Channel 6	Stop/Strobe
Channel 7	Dimmer
Channel 8	Linear Frost
Channel 9	Ovalizer
Channel 10	Zoom
Channel 11	Pan
Channel 12	Pan fine
Channel 13	Tilt
Channel 14	Tilt fine
Channel 15	Reset
Channel 16	Lamp ON - OFF

Sales codes

C 61080	ALPHA WASH TH
L 10074	HMI 575 W/SEL lamp
L 10075	MSR 575 W/HR lamp
F21165	Foam Shell
F21160	Flight case for 2 projectors (including 2 foam shells)

CLAY PAKY S.p.A.

Via Pastrengo, 3/b - 24068 Seriate (BG) Italy
Tel. +39 - 035 - 65 43 11 - Fax +39 - 035 - 30 18 76
cp.sales@claypaky.it - www.claypaky.it



PROFESSIONAL SHOW LIGHTING