

POINT

Colour Changer

Clay Paky's
new intelligent
micro-projector



PROFESSIONAL SHOW LIGHTING

Point is the small and intelligent color changer that features all the technology of large professional Clay Paky projectors and creates unique atmospheres in public and private settings, venues and outlets.

Point projects 7 different colours of varying intensity.

It is lightweight, elegant, easy to handle and install, and works both automatically or controlled from a lighting desk.

Unlike virtually any other projector of this kind, Point do not need external or electronic transformers; Point has everything built-in, which cuts installation costs significantly.

Point can also project images on any surface using the optional lens kit.

The product comes in three different versions: **Point** (bracket-mounting on any surface), **Point IN** (flush-mounting, with adjustable angle and rotation), **Point MH** (with moving body, for moving projections).

More versatile than ever...

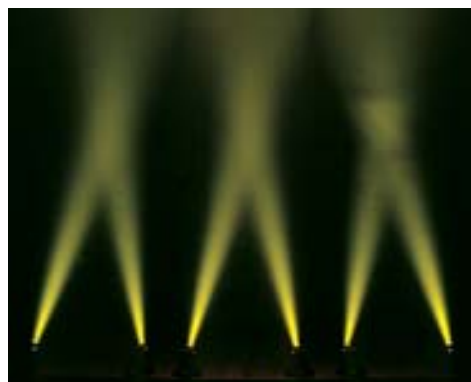

POINT MH



Code C71020

Type: Moving body projector.

Colours available: black and silver.

Power supply: 230 V 50 Hz.



Consumption: 100 VA.

Working Position: any.

Cooling: by convection.



Accessories:

1.  **Code C71101**
Lens kit
1:2,8 / 90 mm
+ gobo mount
2.  **Code C71103**
Spill Ring kit
Colours: black and silver
3.  **Code C71102**
Fixing Plate Kit

Lamp:

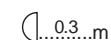

- Voltage: 12 V
- Power: 50 W
- Colour temperature: 3.100 K
- Luminosity: 15.000 cd
- Beam angle: 10°
- Average life: 4.000 hours
- Connection: GU 5,3
- Any working position

Master / Slave operation in automatic mode.

A projector can pilot up to 100 projectors and can set (with or without dimmer) both the colour sequence and colour timing from 3 to 360 seconds.

Also available are 5-speed settings for Pan and Tilt, maximum and minimum resolution for Pan and Tilt, Sound-to-Light.

Operation with DMX 512 digital signal

You can program and obtain any colour sequence or movement using a DMX 512 remote control.

Control channels:

- | | |
|-----------------------|---|
| 1 Colour wheel | 7 colours, obtained using pure and selected dichroic filters. |
| 2 Dimmer | Gradual electronic dimmer 0 -100 % |
| 3 Pan | 360° movement on horizontal axis and max speed 2.3 seconds |
| 4 Tilt | 208° movement on vertical axis and max speed 1.5 seconds |

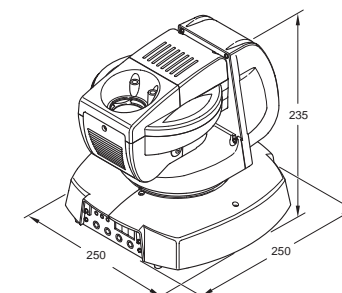

POINT



Code C 71001

Type: Projector with bracket for mounting on any surface.

Colours available: black and silver.

Power supply: 230 V 50 Hz.

Consumption: 60 VA.

Working Position: Any.

Cooling: by convection.



Lamp:

| | | |
|--|-------------------------|--------------|
| | Halogen Decostar 51 IRC | included |
| | | Cod. L 10056 |

- Voltage: 12 V
- Power: 50 W
- Colour temperature: 3.100 K
- Luminosity: 15.000 cd
- Beam angle: 10°
- Average life: 4,000 hours
- Connection: GU 5,3
- Any working position

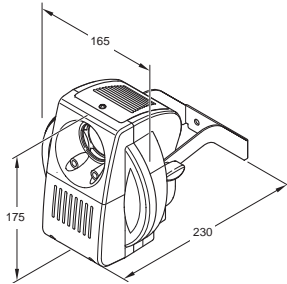

Accessories:

- Code C71101**
Lens kit
1:2,8/90 mm
+ gobo mount
- Code C71103**
Spill Ring kit
Colours: black and silver

⌒...0.3...m

Master / Slave operation in automatic mode.

A projector can pilot up to 100 projectors and can set (with or without dimmer) both the colour sequence and colour timing from 3 to 360 seconds.

Operation with DMX 512 digital signal

You can program and obtain any colour sequence or movement using a DMX 512 remote control.

Control channels:

- | | |
|-----------------------|---|
| 1 Colour wheel | 7 colours, obtained using pure and selected dichroic filters. |
| 2 Dimmer | Gradual electronic dimmer 0 -100 % |

POINT IN



Code C 71010

Type: flush-mounting, with adjustable angle and rotation

Colours available: white and silver.

Power supply: 230 V 50 Hz.

Consumption: 60 VA.

Working Position: Any.

Cooling: by convection.



Lamp:

| | | |
|--|-------------------------|--------------|
| | Halogen Decostar 51 IRC | included |
| | | Cod. L 10056 |

- Voltage: 12 V
- Power: 50 W
- Colour temperature: 3.100 K
- Luminosity: 15.000 cd
- Beam angle: 10°
- Average life: 4,000 hours
- Connection: GU 5,3
- Any working position

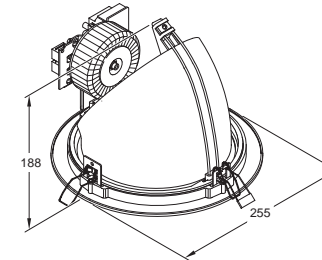

Accessories:

- Code C71101**
Lens kit 1:2,8/90 mm
+ gobo mount
- Code C71103**
Spill Ring kit
Colours: white and silver

⌒...0.3...m

Master / Slave operation in automatic mode.

A projector can pilot up to 100 projectors and can set (with or without dimmer) both the colour sequence and colour timing from 3 to 360 seconds.

Operation with DMX 512 digital signal

You can program and obtain any colour sequence or movement using a DMX 512 remote control.

Control channels:

- | | |
|-----------------------|---|
| 1 Colour wheel | 7 colours, obtained using pure and selected dichroic filters. |
| 2 Dimmer | Gradual electronic dimmer 0 -100 % |



Lamps available

| Beam angle | Luminosity | Code |
|--------------------|------------|---------|
| 10° (standard) | 15.000 cd | L 10056 |
| 24° (upon request) | 5.700 cd | L 10068 |
| 38° (upon request) | 2.850 cd | L 10069 |
| 60° (upon request) | 1.430 cd | L 10070 |

Intensity diagrams

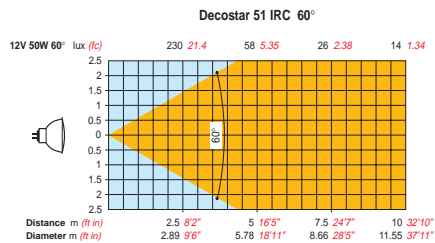
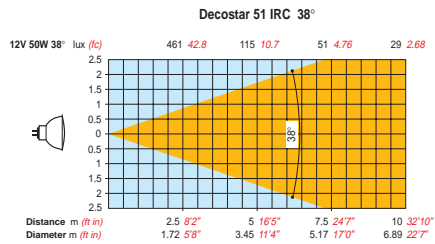
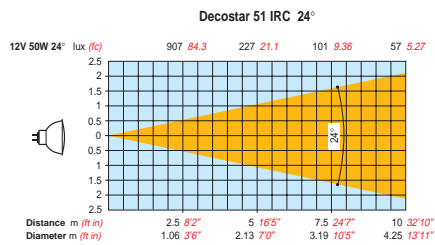
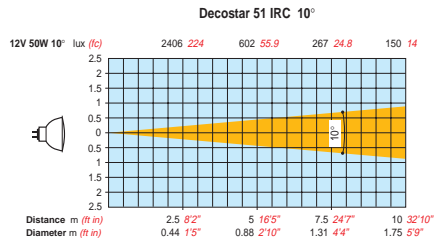

Interconnection

Connection to the mains supply and DMX 512 control signal line.

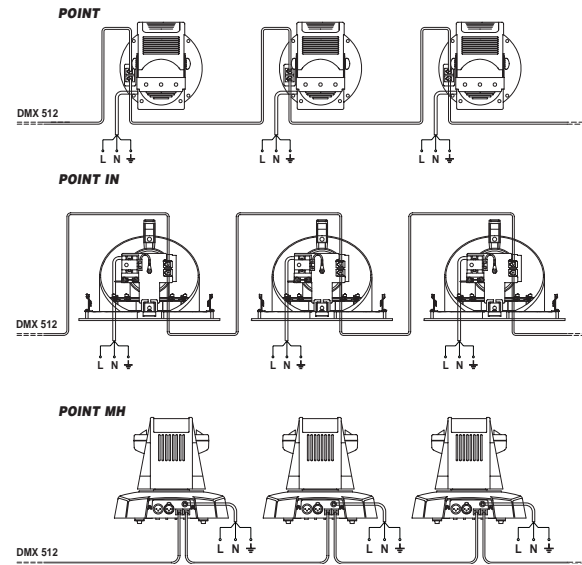

Accessories

Code C 71101

Lens kit

1:2.8/90 mm + gobo mount:
Point, Point IN, Point MH colour changer can be transformed into projectors for logos, promotional messages and signs (only with standard lamp). The accessory can be fitted with metallic or dichroic gobos \varnothing 31.5 mm and max image dimensions \varnothing 23 mm.

Colour: black.

1.

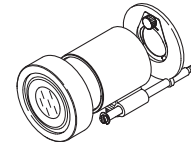

Decostar 51 IRC 10°
with gobo support, \varnothing 31,5 mm gobo,
 \varnothing 23 mm image and lens 1:2.8/90 mm

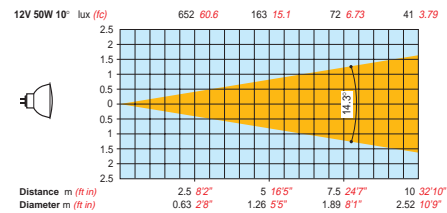

Code C 71103

Spill Ring kit

Used to reduce beam spill of the fixtures.

Colour: black, silver and white.

2.

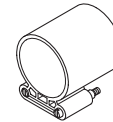

Code C 71102

Fixing Plate kit

Used for installing Point MH on supporting structures

Colour: black.

3.

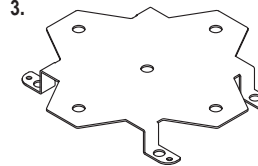

Code C52175

Tubular truss hook

Used for fixing on tubular trusses with 40-50 mm diameter.



Accessory fitting diagram

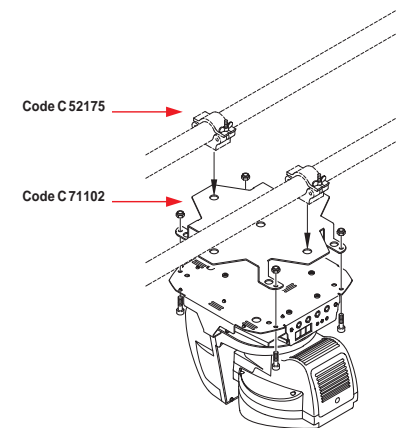
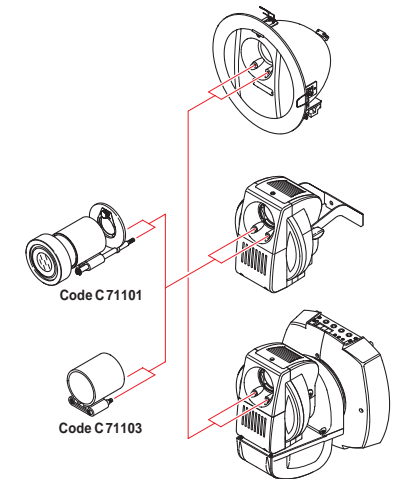



CLAY PAKY S.p.A.

Via Pastrengo, 3/b - Seriate (BG) Italy - Tel. +39-035-654311
Fax +39-035-301876 - www.claypaky.it • cp.sales@claypaky.it



PROFESSIONAL SHOW LIGHTING