

C61604 – TOP HAT KIT CONTENTS

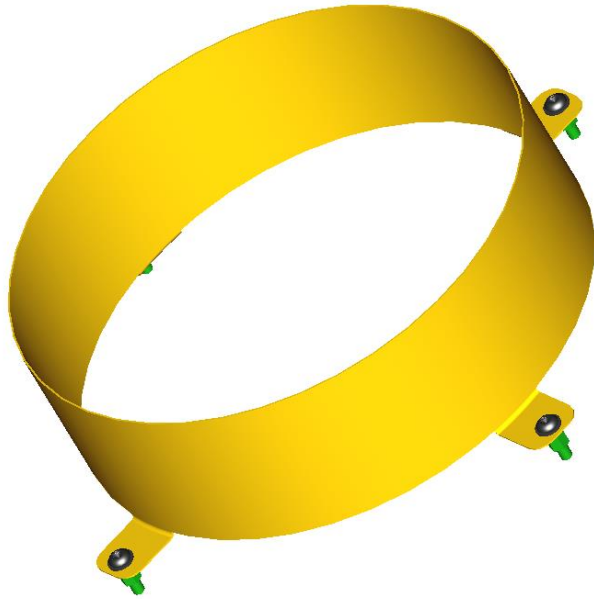

1pc. Top Hat - 322100/001
4pcs. Spacers – DIS03R/001
4pcs. Screws - VTB00G/001
4pcs. Washers - ROP005

TOP HAT assembly instruction



Unscrew the 4 screws and remove the front plastic cover.

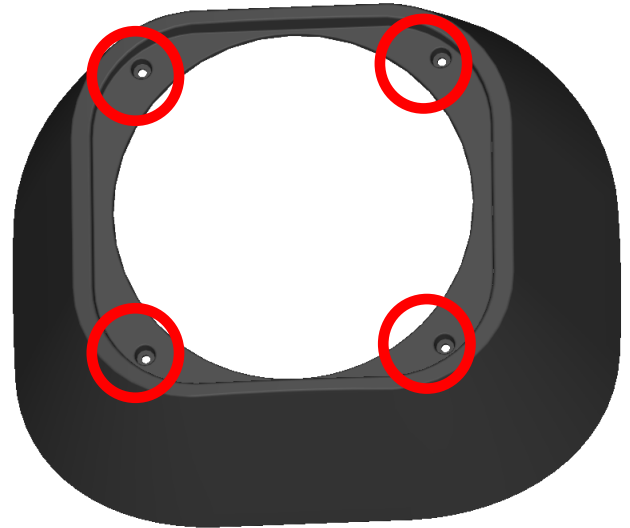

Remove the 4 screws from the plastic cover.



Put in place the front plastic cover without the screws.



Screw the 4 spacers DIS03R/001.



Put the Top Hat in place 322100/001 as shown in the picture.



Screw the 4 screws (VTB00G/001) + 4 washers (ROP005) to fix the TopHat to the spacers assembled before.